



**EVERGLADES SOCIETY FOR  
HISTORIC PRESERVATION**

*Dedicated to our Unique History*

P O Box 46, Everglades City, FL, 34139

(239) 695-2905 or (239) 451-0265

[www.evergladeshistorical.org](http://www.evergladeshistorical.org)

# Everglades Historical Village



- SAVE OLD BUILDINGS DAMAGED BY HURRICANE IRMA
- CREATE A FOCAL POINT FOR TOURISTS AND LOCAL LIFE

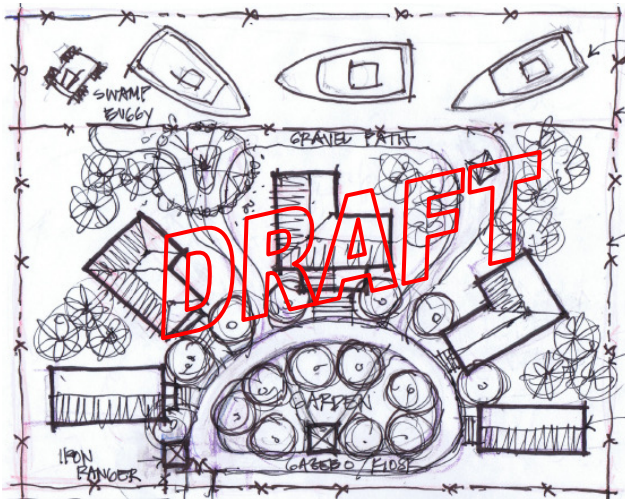

sketch thanks to Dayna Fendrick, Urban Green

*We want to establish an Historical Village in rural Everglades City, an outpost of Olde Florida, and need help with funding for this innovative & ambitious project.*

We envision that little buildings donated by owners will be moved to a site in town and rented to small businesses (eg, book store, boutique with local arts & crafts). It could also be an information center for our Chamber of Commerce.

We hope to include historic fishing boats and a garden of native plants with frequent sales including interesting orchids.

**HELP US NOW WITH YOUR SUPPORT! ...**



## Everglades Historical Village

ESHP, P.O.Box 46, Everglades City, FL, 34139

or donate with a credit/debit card at our website [www.evergladeshistorical.org](http://www.evergladeshistorical.org)

ESHP reserves the right to allocate donations to its Hurricane Recovery Fund if the Historical Village does not come to fruition but we will inform you in advance of this decision.

- \_\_\_ Sponsor (\$10,000 plus) for name on front fence and acknowledgement on our website
- \_\_\_ Patron (\$1,000 - \$9,999) for name on special plaque
- \_\_\_ Donor (\$100 - \$999) for guided tours & personal welcome with advance notice
- \_\_\_ Double my donation! My employer \_\_\_\_\_ has a matching gift fund.

I enclose a check for \$ \_\_\_\_\_ payable to ESHP with memo line "Historical Village".

name \_\_\_\_\_

address/POBox \_\_\_\_\_

city \_\_\_\_\_ ST \_\_\_\_\_ ZIP \_\_\_\_\_

phone \_\_\_\_\_ cell \_\_\_\_\_

email \_\_\_\_\_

ESHP is a registered 501(c)(3) not-for-profit corporation so your donation may be tax-deductible. We are registered with Florida Department of Agriculture & Consumer Affairs, CH39290. A copy of the official registration and financial information may be obtained from the Division of Consumer Services by calling toll-free 800-435-7352 within the State. State registration does not imply endorsement, approval, or recommendation by the State.